

UPDATE – ongoing works in your area: Temporary closure of La Trobe Street at Elizabeth Street

23 October 2023

Elizabeth Street Sewer Upgrade Project

To cater for growth in Melbourne's CBD, Greater Western Water is constructing a new sewer in Elizabeth Street between Lonsdale and Victoria streets. The project will be delivered for Greater Western Water by Rob Carr Pty Ltd.

What we are doing and when

The temporary closure of the intersection of La Trobe Street and Elizabeth Street (see map overleaf) which started on Wednesday 30 August 2023 will now be extended and may take up until Thursday 30 November 2023 to be complete. This work will take place during night-time and includes vacuum excavation and non-destructive water digging. We will update you about any changes as the works progress.

Thank you for your patience while we complete these important works.

Traffic impacts

- La Trobe Street at Elizabeth Street will be temporarily closed at night during working hours up until Thursday November 2023.
- This temporary closure will only impact the intersection of La Trobe Street at Elizabeth Street.
- A detour will be in place for westbound traffic on La Trobe Street during this time.
- Pedestrians will be diverted around the closure.
- Footpaths and access to businesses will be maintained at all times.

What to expect

- Work will take place between 9pm and 5am Monday to Thursday and is expected to be complete by Thursday 30 November 2023.
- There will be periods of moderate noise from use of non-destructive digging trucks.
- This work will not impact your sewerage or water supplies.

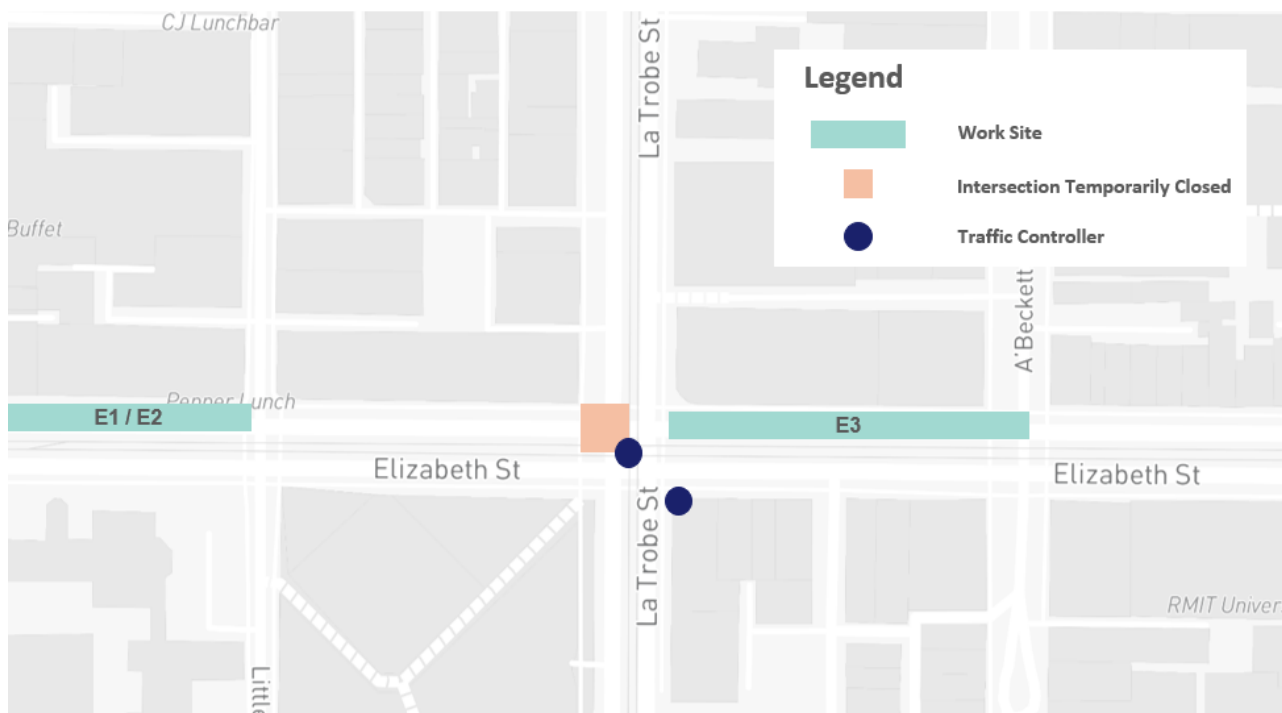

Need more information?

For more information about this project or to register for email updates, scan the QR code or visit: **yoursay.gww.com.au/elizabeth-st**

If you have any questions or concerns, please contact:

Phone: 03 9869 0980 (during business hours)

Email: ElizabethStreet@smec.com

Customer service: 13 44 99 (24 hours)

